



Opoz 5000

Multi-Function POS System

## Multi-Function



Winner of iF Design Award 2005



### Flexibility

90°



60°



30°



Provide total 3 different viewing angles, can meet almost all demands of different environment. 30° is suitable for standing operation; 60° is suitable for sitting operation; 90° is suitable for wall mounting.

12"/15" Touch Monitor are available



### Features

- At the hardware components, including host unit, 12.1" TFT touch screen, customer display, RFID & MSR reader, combine into a space
- Patent design on LCD with 3 adjustable viewing angles: 30°, 60° and 90°
- Movable 2x20 VFD customer display by button-up lock
- Movable RFID & MSR reader
- Special design of opening cash drawer by customer display
- The rubber painted cover can withstand the scratch primely
- CF & RMA Slot, enable to easy upgrade



**Manicon Technology Limited**

Unit 12, 8/F, New City Centre, Kwun Tong,  
Kowloon, Hong Kong

Tel: 2836-3162 Fax: 2836-3093

E-Mail: [sales@manicon.com](mailto:sales@manicon.com)

Web Page: <http://www.manicon.com>

**Ultra-Low Voltage CPU**

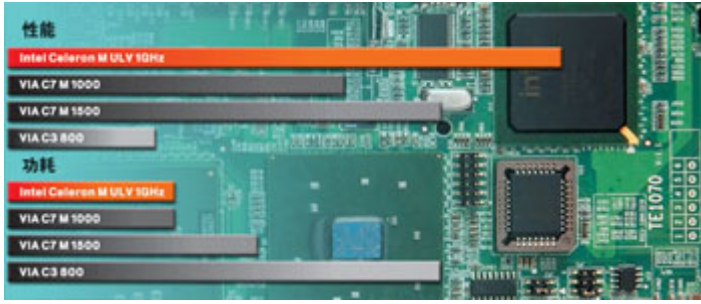

Built-in with Intel ULV series Low Power CPU. Ensure the POS machine can work well in any environment.

**POS Control Motherboard**

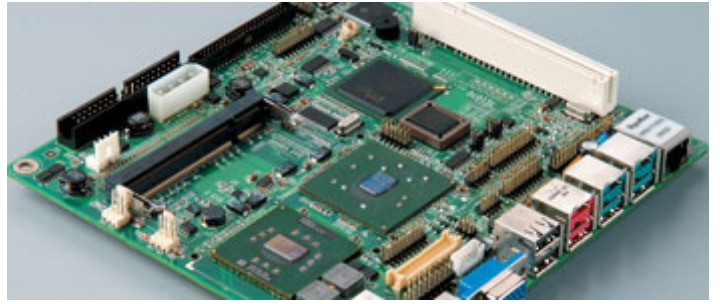

The special high-density design 170 x 170 mm POS control motherboard built-in with Intel Celeron M ULV CPU, ultra-small elements.

**Hidden Interface**



The new hidden interface design constructs a clean and safer working condition.

**Easy Maintenance**



Opening only by 2 screws, the modularize design allows easy maintenance.

**Fully Metal Thermal Transmittance**



The strong aluminum frame can deliver heat quickly.

**Programmable Keyboard**



36 key Fully Programmable Keyboard(Cherry Key), MCBF reach 50 Million knocks.

**MSR Reader**



Full 3 tracks identification, can read data from any Megcard.

**Customer Display**



2 x 20 ( 5 x 7 ) Dot Matrix VFD Display can be combined on the host or stand alone.

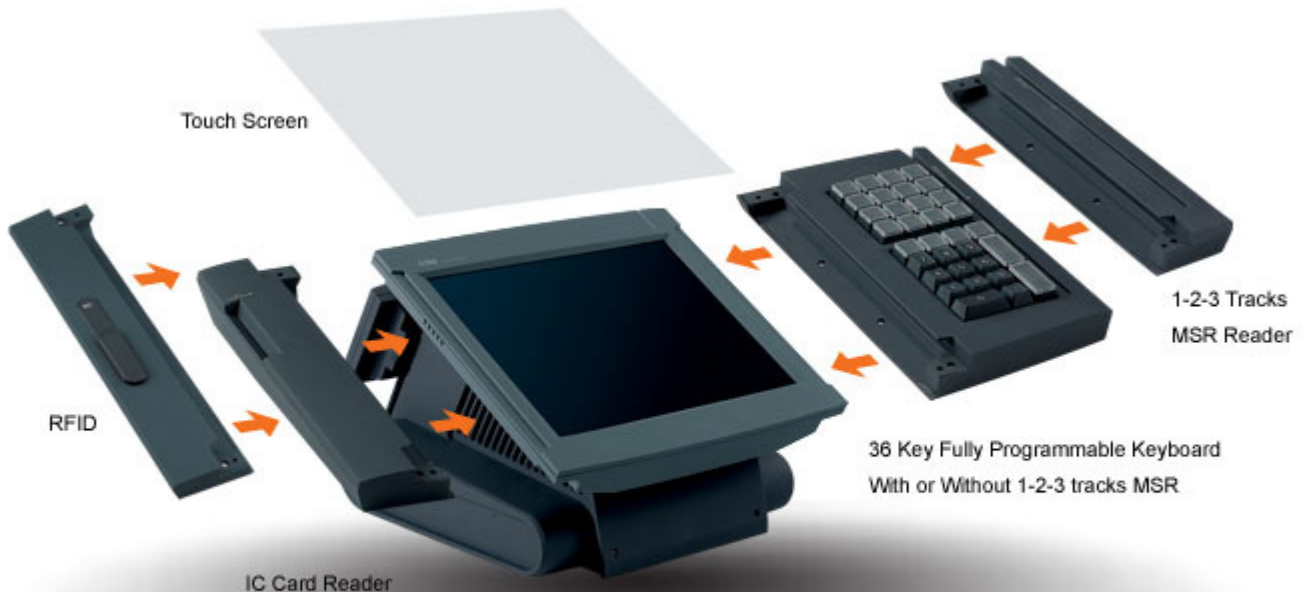

## Specifications

### Host

Mainboard	POS control mainboard
CPU	Intel Celeron-M ULV 1.0 GHz
HDD	2.5" 80G
RAM	512MB(Up to 2G)
Power	70W/110~220V

### Interface

Customer Display	1 x internal (by USB)
Parallel Port	1 x external
Serial Port	1 x external
Keyboard	1 x PS/2
Powered USB	1 x 12V, 1 x 24V
USB	1 x USB2.0
Mouse	By USB
VGA	1 x external
LAN	1 x 10M/100M
CF Slot	1 x internal
RMA exertion slot	1 x internal
Cash Drawer	N/A

### Touch Monitor

Monitor	12.1" TFT LCD (1024x768) 15" TFT LCD (1024x768)
Touch Panel	ELO 5 wire resistive touch screen, water-spill proof, 4096 x 4096, 35 million touches

### Option

Customer display	2 x 20 (5 x 7) Dot Matrix VFD. Combined on the host or stand alone pole display.
Keyboard	36 Key fully programmable keyboard (Cherry key) (for 12inch screen only)
MSR	Support 1-2-3 tracks
RFID	S50 &S70 IC card, combined on the left-side of Touch Monitor
Printer	Opoz RP-5080 80mm high speed thermal printer.
Scanner	5 Directions, 1200 line/s, 650nm visual laser diode

### Dimension

W x L x H	360 x 436 x 280mm (with 15" TFT LCD 60degree) 360 x 400 x 250mm (with 12" TFT LCD 60degree)
-----------	--



### Manicon Technology Limited

Unit 12, 8/F, New City Centre, Kwun Tong,  
Kowloon, Hong Kong

Tel: 2836-3162 Fax: 2836-3093

E-Mail: [sales@manicon.com](mailto:sales@manicon.com)

Web Page: <http://www.manicon.com>